

**NARROWBOAT NUMBER 16**  
**58 FOOT NARROWBOAT**

Moored at:  
**UNION WHARF**  
**MARKET HARBOROUGH**  
**LEICESTERSHIRE**

Presented by boat owners  
**Andicraft Fabrications Ltd**

**TO ARRANGE A VIEWING, please call**  
**Sharon Peach at Union Wharf Marina on**  
**07740 474937**

**Boat Type**  
 Narrowboat

**Built In**  
 2024

**Shell Builder**  
 Andicraft Fabrications

**BSS due**  
 January 2028

**Stern**  
 Semi-traditional

**Fit out by**  
 Andicraft Fabrications

**Propulsion**  
 Canal Line 42

**Inverter**  
 Vetus 3kw, 120a

**Last blacked**  
 December 2023

**Berths**  
 2 + space for  
 sofabed/dinette

**Toilet**  
 Cassette

**Batteries**  
 6 x 6V 660ah

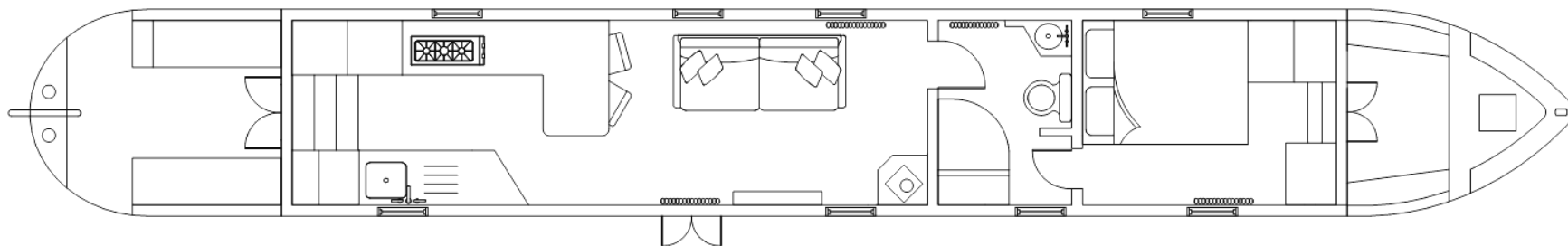

Engine	Tanks	Heating	Batteries	Solar	Bow & stern thrusters	Windows
Canal Line 42 Testing hours	Fuel tank 230 litres	Diesel heating Webasto	12v service batteries 6v x 6 660ah	500w 2 x 250w	2 x Vetus 65kgf	Double glazed
Drive type Shaft drive	Water tank 480 litres	Solid fuel stove Morso Squirrel	Starter & stern thruster 110ah SFL	Solar controller Victron 100/30		
Gearbox PRM 150D2	Cassette waste 17 litres	Calorifier Twin coil 55 litres + 1kw immersion	Bow thruster 2 x SFL			